



Declaration of Performance

Identification Code: VE4-275-STST

Meeting the requirements of Annex ZA, EN 845-1:2013 +A1:2016

Description of Use:

Symmetrical wall tie classed as type 4 light duty housing tie used to connect two leaves of a cavity wall from 126-150mm.

Testing Body: Lucideon Ltd
Queens Road
Penkull
Stoke on Trent
ST4 7QL

Notification Body No: 1289

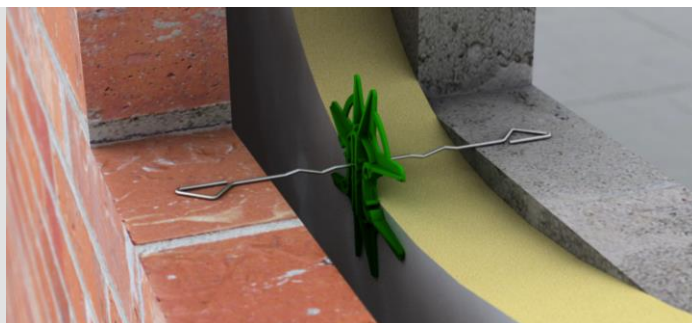

Performance:

| | |
|--|------------------------------|
| Tensile Load Capacity: | 1640N |
| Compressive Load Capacity: | 380N |
| Displacement at $\frac{1}{3}$ Load: Tension: | 0.91mm |
| Displacement at $\frac{1}{3}$ Load: Compression: | 0.27mm |
| Water Shedding Capacity: | Resistant |
| Durability: | Material coating reference 3 |
| Dangerous Substance: | N/A |
| Minimum Embedment: | 62.5mm |
| Minimum Mortar Joint: | 10mm |

Authorised Signature

Philip Travis, Managing Director

16th February 2023

