

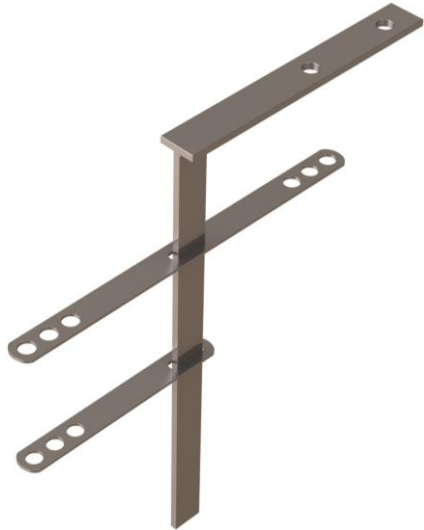

Sliding Anchor Systems

A range of heavy duty (welded) and light duty (bent and/or twisted) stems. Available in standard stem lengths, heads sizes and hole configurations with other options available on request. This range of products secure cavity walls to overhead structures, whilst accommodating vertical movement. Used in conjunction with one or two way sliding ties (ordered separately).



Product

WBS Welded B Stem

Offset head where there is no fixing directly above. Heavy Duty.

Hole size standard 12mm to suit M10 expansion bolts or M10 head bolt.

Design load resistant dependant on upper tie being a maximum of 75mm down from head

Sizes:	300mm	500mm
	350mm	550mm
	400mm	600mm
	450mm	

Installation

Tightening Torque:	
M8 M.D. Anchor	15Nm
M8 Isolated setscrew	14Nm
M8 H.S.M. Bolt	25Nm

Safety Precautions

WBS Welded B Stems are manufactured from sheared plate and strip so may contain sharp edges. Suitable personal protection should always be used when handling/installing these products.

Head Office: Vista Engineering Ltd, Carr Brook Works, Elnor Lane, Whaley Bridge, High Peak SK23 7JN
Tel: Sales: +44 (0) 1663 736 700 Fax: +44 (0) 1663 736 710

Scotland Office: Vista Engineering Ltd, 79 Dunn Street, Parkhead, Glasgow, G40 3PA
Tel: +44 (0) 141 613 3144 Fax: +44 (0) 141 613 3031

web: www.vistaeng.co.uk email: sales@vistaeng.co.uk

