

## Masonry to Masonry Wall Ties

These products act to secure two leaves of a cavity wall to each other, allowing them to act as one structurally. Most cavity ties are available with a dedicated clip to secure insulation (usually in sheet form) within the cavity.

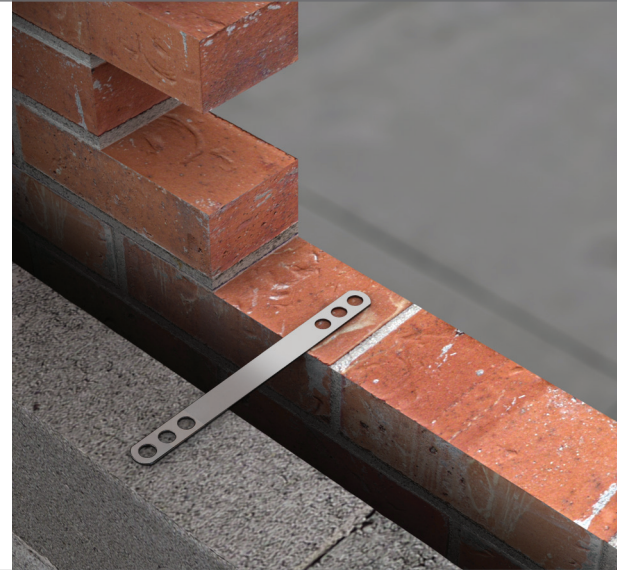
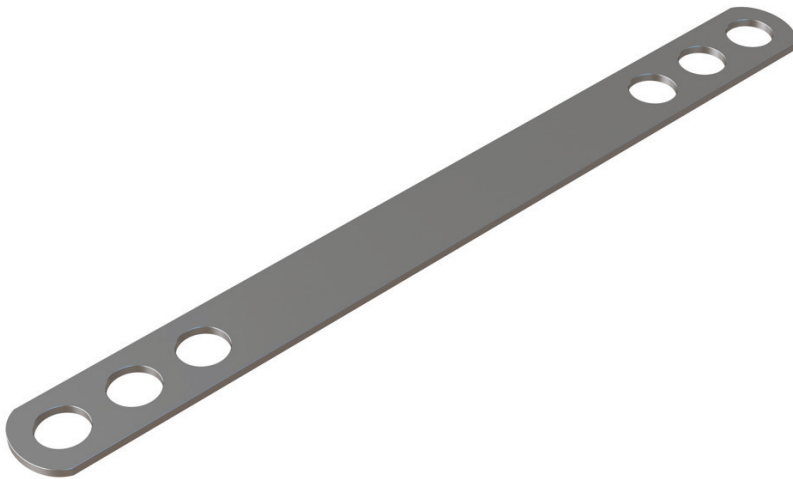

### Product

#### VS4 Heavy Duty Flat Safety Tie

Used in full fill cavities or where the prevention of moisture travelling across the cavity is not an issue. Also for Collar jointed walls (please specify).

250mm long stainless steel Wall Ties supplied by Vista Engineering Limited, were tested in tension and compression over a nominal cavity width of 125mm in accordance with BS EN 846-6 Methods of Test for Ancillary Components for Masonry. Part 5; Determination of tensile and compressive load capacity and load displacement characteristics of wall ties (Couplet test).

##### Part E - Type B ties for external walls where a Type A tie is not suitable

These ties must either be double triangle tie to BS1243 (only used in 50mm-75mm cavities) or ties with a measured dynamic stiffness of  $<113\text{MN/m}^3$  taking both cavity width and tie density into account.

Independent tests have proved that the Vista VS4 Heavy Duty Flat Safety Tie has a measured dynamic stiffness of  $<113\text{MN/m}^3$  in a 100mm cavity and is therefore more than suitable for external walls at a standard density of 2.5 per square metre.

### Test Results

Summary of Declared Values of Vista Engineering Limited 250mm long ties tested in tension and compression at a standard cavity width of 125mm.

Load Direction	Maximum Declared Value at Ultimate Load (N)
250mm Long Tie @ 125mm Cavity	
Tension	> 5000
Compression	> 5000